



LSS26500

2.9V Lithium Sulfur Dioxide Cells

Benefits

- High discharge current at low temperature application.
Energy density,(330Wh/Kg).
- Stable voltage with open circuit voltage greater than 2.9V and operating voltage 2.5V to 2.8V.
- Wide range of operating temperature (-50 °C~+75 °C).
- Long shelf life(over 10 years at normal room temperature).

Main application

- Intelligent Instrument and meter
- Memory and standby power
- Alarms and security devices
- Automotive electronics
- Electronic toll collection
- Military devices

Electrical characteristics (20±2 °C)

Nominal capacity	3.7Ah
Nominal voltage	2.9V
Maximum recommended continuous current	2000mA
Maximum recommended pulse current	4000mA
Operating temperature range	-55 °C~+65 °C

 U.L. Component Recognition MH 29130

Physical characteristics

Diameter[max]	26.2mm
Height[max]	50.5mm
Typical weight	48g

Available terminations

S: Standard terminations

T: Solder tabs

P: Axial pins

Special termination are available upon request.

MSDS is available upon request.

EEMB Co., Ltd.

Addr: A,B,C,D, 25th/F, Bldg.A, Fortune Plaza, Shenzhen, P.R.China

Tel:+86-755-83022275

Fax:+86-755-83021966

[Http://eemb.com](http://eemb.com)

E-mail:Global@eemb.com



LSS26500

2.9V Lithium Sulfur Dioxide Cells

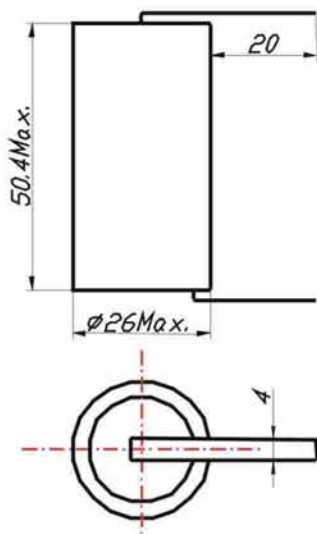

S: Standard termination

Post Code: 430056

Tel: +86-27-59405283 59402705

Fax: +86-27-84662179

Discharge Characteristics at (20±2°C)

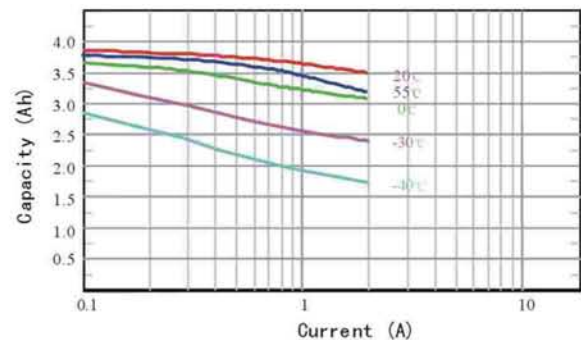
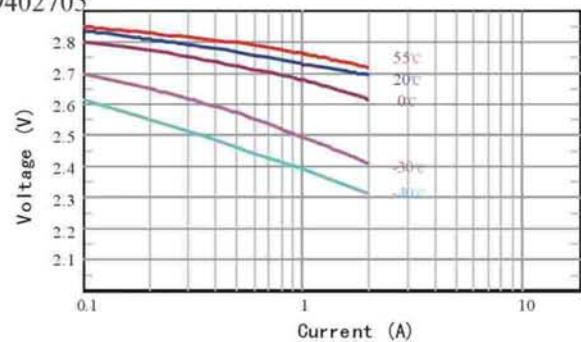
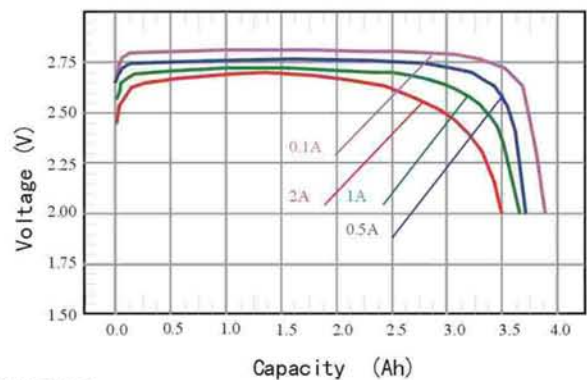

Warning:

- Fire, explosion and burn hazard.
- Do not recharge, short circuit, crush, disassemble, heat above 100°C incinerate.
- Do not use the battery beyond permitted temperature range.

EEMB Co., Ltd.

Addr: A,B,C,D, 25th/F, Bldg.A, Fortune Plaza, Shenzhen, P.R.China

Tel:+86-755-83022275

Fax:+86-755-83021966

Http://eemb.com

E-mail:Global@eemb.com