

## 2-phase Hybrid Stepping Motor, DM60xxE

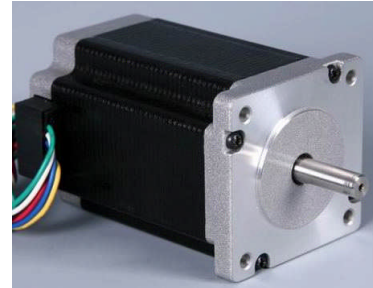

Item	Specifications
Step Angle	1.8°
Step Angle Accuracy	±5% (full step, no load)
Resistance Accuracy	±10%
Inductance Accuracy	±20%
Temperature Rise	80°C Max. (rated current, 2 phase on)
Ambient Temperature	-20°C ~ +50°C
Insulation Resistance	100MΩMin., 500VDC
Dielectric Strength	500VAC for one minute
Shaft Radial Play	0.02Max. (450 g-load)
Shaft Axial Play	0.08Max. (450 g-load)
Max. radial force	75N (20mm from the flange)
Max. axial force	15N



Model	Parallel /Series	Rated Voltage (V)	Current /Phase (A)	Resistance /Phase (Ω)	Inductance /Phase (mH)	Holding Torque (N·m)	Rotor Inertia (g·cm <sup>2</sup> )	Weight (kg)	Length (mm)
DM6047E	P	2.1	2.8	0.75	2.0	1.10	275	0.60	47
	S	4.2	1.4	3.0	8.0				
DM6056E	P	2.52	2.8	0.9	3.6	1.65	300	0.77	56
	S	5.04	1.4	3.6	14.4				
DM6067E	P	3.36	2.8	1.2	4.6	2.10	570	1.2	67
	S	6.72	1.4	4.8	18.4				
DM6088E	P	4.17	2.8	1.5	6.8	3.10	840	1.4	88
	S	8.34	1.4	6.0	27.2				

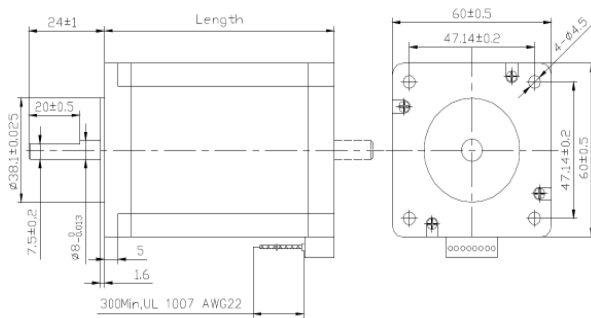

Model	Recommended Driver
DM6047E	DM403A/T DMD605, DMD808A
DM6056E	
DM6067E	
DM6088E	

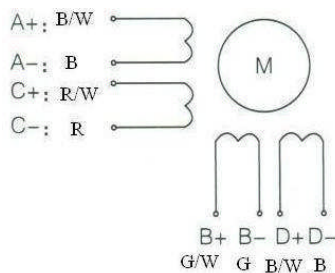

Parallel

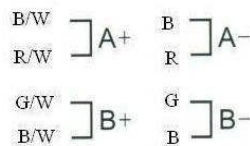

Series

