



Standard version. Anthropomorphous five axes robot, suitable for painting in line, where exist air or floor conveyor systems; if necessary it is synchronized to the conveyor for running after the pieces. Its structure and the control system make it one of the fastest and accurate five axes Robots, as well as being extremely manageable, essential quality for the programming.

GR-530 ST



TECHNICAL FEATURES	
PHISICAL	
Number of robot axes	5
Number of external axes	3
Working area	1.950
Wrist capacity	3 kg
Installation	Floor/Ceiling/Wall
Programmation	Self teaching
Robot weight	350 kg
ENVIRONMENT	
Robot protection degree	IP 65
Robot Explosion protection (Atex)	Category: II 2 G EEx p II T4
OPTION	
External axes	
Synchronization to the conveyor	
Tele service	
ATEX	



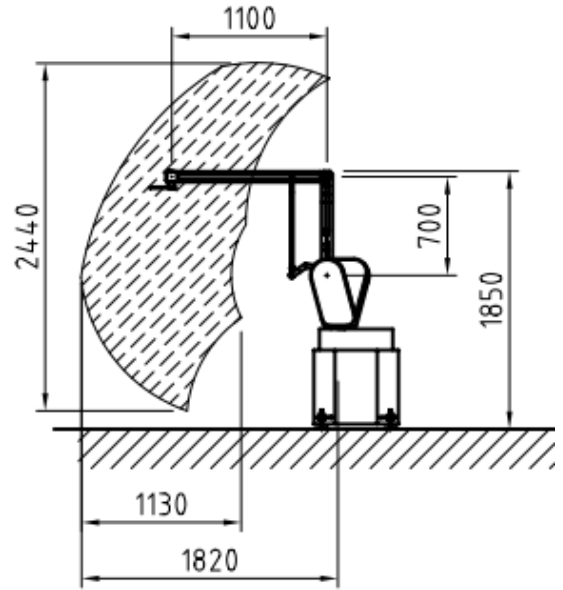
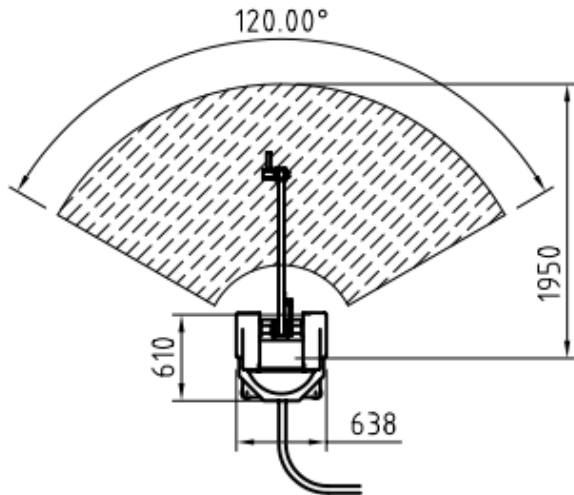

GR-530 G

Carousel version. The Robot is complete of a carousel with three or more arms. The pieces can be loaded manually or in automatic way in a safe area; the carousel provides for the positioning of the pieces at the frontal part for the working, and it brings them in the unloading area. The arms, thanks to their configuration, allow performing easily the programming, they are provided of rotation group synchronized with the robot and they can be arranged with different piece supports according to the demand. The rotation of the carousel is made by controlled axe with regulation of the speed.



TECHNICAL FEATURES	
CARROUSEL	
Movement	Servo controllato
Arms number	2-3-4
Arm weight capacity	25 kg
Robot weight	750 Kg
PIECES TURNING DEVICE	
Movement	Servo controlled and sincronized
OPTIONS	
Adjustable piece supports	

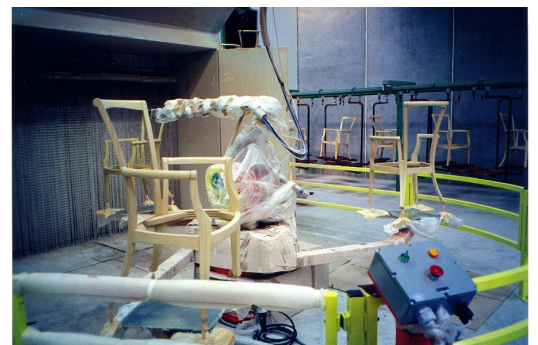

CMA Robotics Spa
 Via P.P. Pasolini 35/15
 33040 Pradamano (UD) Italy
www.cmarobot.it - info@cmarobot.it