

# SOCKET HEAD SCREWS

Y5 Series

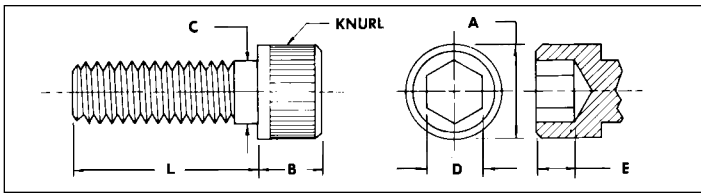

\*Knurl at PIC option on sizes 0 and 2.

Material: 300 Series Stainless Steel  
Thread: Class 3A

Sold In Increments of 10 pieces.

TO ORDER SOCKET HEAD SCREWS:

1. Select series code.
2. Select code for thread size desired.
3. Select code for length.

ORDERING INFORMATION

Specify: Type-Screw Size-Length

Example: Y5-#6-32-3/4 Long

Order Part No. Y5-6-Y

Code and Length L	#0-80 Dash - 0	#2-56 Dash - 2	#4-40 Dash - 4	#6-32 Dash - 6	#8-32 Dash - 8	#10-32 Dash - 10
R = 1/8	✓	✓	—	—	—	—
S = 3/16	✓	✓	✓	✓	—	—
T = 1/4	✓	✓	✓	✓	✓	✓
U = 5/16	✓	✓	✓	✓	✓	✓
V = 3/8	✓	✓	✓	✓	✓	✓
W = 1/2	—	✓	✓	✓	✓	✓
X = 5/8	—	—	—	✓	✓	✓
Y = 3/4	—	—	—	✓	✓	✓
Z = 1	—	—	—	—	✓	✓

Dash indicates length not available for thread size.

Screw Size C	A (Max.)	B (Max.)	D (Nom.)	E (Min.)
# 0-80	.096	.060	.050	.025
# 2-56	.140	.086	5/64	.038
# 4-40	.183	.112	3/32	.051
# 6-32	.226	.138	7/64	.064
# 8-32	.270	.164	9/64	.077
#10-32	.312	.190	5/32	.090

## SOCKET HEAD SCREW KITS

Description of Contents	Number of Parts	Part No.
Socket Head Cap Screws-Stainless Steel ASA 1960 Series class 3A threads #0-80 to #10-32 Assorted lengths.	220	Y3K

# METRIC SOCKET HEAD SCREWS

MSW4 Series

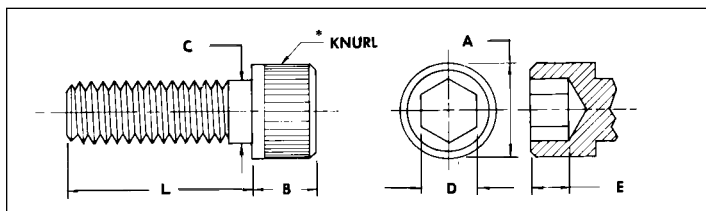

\*Knurl at PIC option

Material: 300 Series Stainless Steel  
Thread: Class 6G

Sold In Increments of 10 pieces.

TO ORDER SOCKET HEAD SCREWS:

1. Select series code.
2. Select code for thread size desired.
3. Select code for length.

ORDERING INFORMATION

Specify: Type-Screw Size-Length

Example: Socket Head -M4-16mm Long

Order Part No. MSW4-4-16

Dimensions Below Are In Millimeters.

Length L	M1.6 x 0.35 Dash - 1	M2 x 0.4 Dash - 2	M3 x 0.5 Dash - 3	M4 x 0.7 Dash - 4	M5 x 0.8 Dash - 5
3	✓	✓	—	—	—
4	✓	✓	—	—	—
5	✓	✓	—	—	—
6	✓	✓	✓	—	—
8	✓	✓	✓	✓	✓
10	—	—	✓	✓	✓
12	—	✓	✓	✓	✓
16	—	—	✓	✓	✓
20	—	—	—	✓	✓
25	—	—	—	✓	✓
30	—	—	—	—	✓
40	—	—	—	—	✓

Dash indicates length not available for thread size.

## SOCKET HEAD SCREW KITS

Description of Contents	Number of Parts	Part No.
Socket Head Cap Screws, stainless steel Assorted sizes from M1.6 to M5 with lengths from 3 to 16.	170	MAK2

Screw Size C	A	B	D	E (Min.)
M1.6	3	1.6	1.5	0.7
M2	3.8	2	1.5	1.0
M3	5.5	3	2.5	1.3
M4	7	4	3	2.0
M5	8.5	5	4	2.7

Phone: 800-243-6125 ■ FAX: 203-758-8271

E-Mail: info@pic-design.com

**PIC** DESIGN

# STAINLESS MACHINE SCREWS

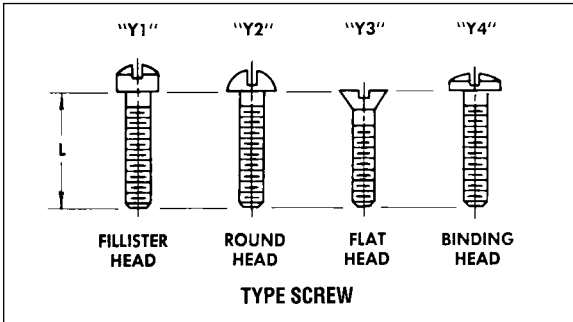

Material: 300 Series Stainless Steel

**HEAD TYPE CODE**

Head Type	Code
Fillister	Y1
Round	Y2
Flat	Y3
Binding	Y4

- TO ORDER MACHINE SCREWS:
1. Select the code for the type of head desired.
  2. Select the code for the thread size desired.
  3. Select the code for the available thread length desired.
  4. If self-locking screws are required add -LL to part number.

ORDERING INFORMATION  
Specify: Type-Screw Size-Length  
Example: Flat Head-#6-32-3/4 Long  
Part No.: Y3-6-Y

**MACHINE SCREW KITS**

Description of Contents	Number of Parts	Part No.
Machine Screws-Fillister Head-Stainless Steel Eighteen Sizes #0-80 through #10-32 Assorted popular lengths.	380	Y2K

## SELF-LOCKING SCREW—NYLON STRIP

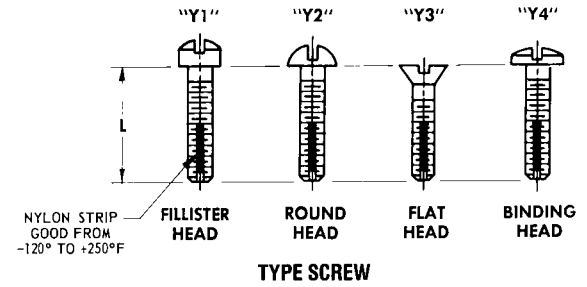

Material: 300 Series Stainless Steel      Nylon per Spec. MIL-LP-410a

**Thread Size and Lengths Available**

Length L and Code	Screw Thread Size and Code					
	#0-80 Dash - 0	#2-56 Dash - 2	#4-40 Dash - 4	#6-32 Dash - 6	#8-32 Dash - 8	#10-32 Dash - 10
R = 1/8	✓	—	—	—	—	—
S = 3/16	✓	✓	✓	—	—	—
T = 1/4	✓	✓	✓	✓	—	—
U = 5/16	✓	✓	✓	✓	✓	—
V = 3/8	✓	✓	✓	✓	✓	—
W = 1/2	✓	✓	✓	✓	✓	✓
X = 5/8	—	—	✓	✓	✓	✓
Y = 3/4	—	—	—	✓	✓	✓
Z = 1	—	—	—	—	✓	✓

Dash indicates length not available for thread size.      ORDERING INFORMATION  
Specify: Type-Screw Size-Length-Self Locking  
Example: Flat Head-#6-32-3/4 Long-Self Locking  
Part No.: Y3-6-Y-LL

# METRIC STAINLESS MACHINE SCREWS

Dimensions Below Are In Inches

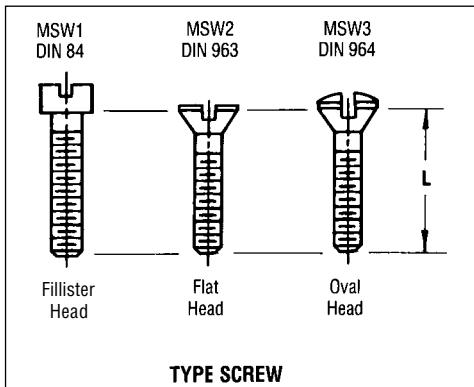

**HEAD TYPE CODE**

Head Type	Code
Fillister	MSW1
Flat	MSW2
Oval	MSW3

Material: 300 Series Stainless Steel

**METRIC MACHINE SCREW KITS**

Description of Contents	Number of Parts	Part No.
Machine Screws, Fillister Head-stainless steel. Eighteen Sizes M1.6 x 0.35 to M5 x 0.8 and assorted lengths 4 to 25.	380	MAK1

- TO ORDER MACHINE SCREWS:
1. Select the code for the type of head desired.
  2. Select the code for the thread size desired.
  3. Select the code for the available thread length desired.

**Thread Size and Lengths Available**

Length L and Code	Screw Thread Size and Code				
	M1.6 x 0.35 Dash - 2	M2 x 0.4 Dash - 3	M3 x 0.5 Dash - 4	M4 x 0.7 Dash - 5	M5 x 0.8 Dash - 6
4	✓	✓	—	—	—
5	✓	✓	✓	✓	—
6	✓	✓	✓	✓	✓
8	✓	✓	✓	✓	✓
10	✓	✓	✓	✓	✓
12	—	—	✓	✓	✓
16	—	✓	✓	✓	✓
20	—	—	✓	✓	✓
25	—	—	✓	✓	✓

ORDERING INFORMATION  
Specify: Type-Screw Size-Length  
Example: Flat Head-M4 x 0.7-8mm Long  
Part No.: MSW2-5-8

# NYLON SCREWS, WASHERS & NUTS

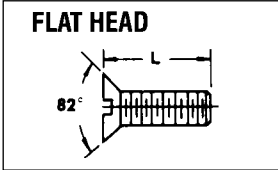
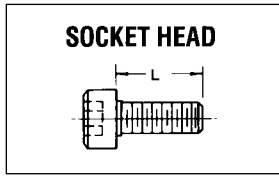
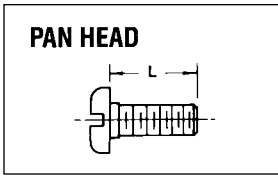

Thread Size	L	Part Number		
		Pan Head	Socket Head	Flat Head
#4-40	1/4	YP-1	YS-1	YF-1
	3/8	YP-5	YS-5	YF-5
	1/2	YP-7	YS-7	YF-7
	3/4	YP-9	YS-9	YF-9
#6-32	1/4	YP-11	YS-11	YF-11
	3/8	YP-15	YS-15	YF-15
	1/2	YP-17	YS-17	YF-17
#8-32	1/4	YP-21	YS-21	YF-21
	3/8	YP-25	YS-25	YF-25
	1/2	YP-27	YS-27	YF-27
	3/4	YP-29	YS-29	YF-29
	1	YP-31	YS-31	YF-31

Thread Size	L	Part Number		
		Pan Head	Socket Head	Flat Head
#10-24	1/4	YP-33	—	YF-33
	3/8	YP-37	—	YF-37
	1/2	YP-39	YS-39	YF-39
	3/4	YP-41	—	YF-41
#10-32	1	—	YS-43	YF-43
	1/4	YP-45	YS-45	YF-45
	3/8	YP-49	YS-49	YF-49
1/4-20	1/2	YP-51	YS-51	YF-51
	1	YP-53	YS-53	YF-53
	1/4	—	YS-55	YF-55
	3/8	YP-57	YS-57	YF-57
1/2	1/2	YP-61	YS-61	YF-61
	3/4	YP-63	YS-63	YF-63
	1	YP-65	YS-65	YF-65

Material: Molded Nylon, Natural Color.

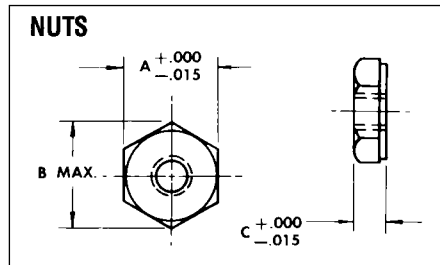
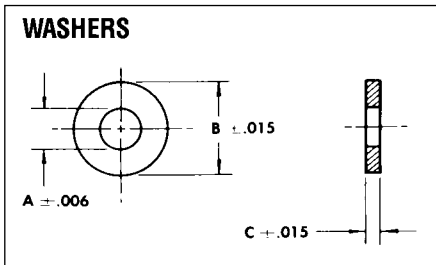

Material: Molded Nylon, Natural Color.

Screw Size	A	B	C	Part No.
# 4	.115	.281	.047	YW-1
# 6	.140	.312	.047	YW-3
# 8	.170	.375	.062	YW-5
#10	.200	.437	.062	YW-7
1/4	.260	.562	.062	YW-9

Screw Size	A	B	C	Part No.
# 4-40	.2500	.289	.098	YN-1
# 6-32	.3125	.361	.114	YN-3
# 8-32	.3438	.397	.130	YN-5
#10-24	.3750	.433	.130	YN-7
#10-32	.3750	.433	.130	YN-9
1/4-20	.4375	.505	.226	YN-11

## NYLON PART KITS

Description of Contents	Number of Parts	Part No.
Pan Head Nylon Screws, Nuts & Washers Six thread sizes (#4-40 to 1/4-20) in Assorted Lengths (1/4" to 1")	500	Y14K
Socket Head Nylon Screws, Nuts & Washers Six thread sizes (#4-40 to 1/4-20) in Assorted Lengths (1/4" to 1")	500	Y15K
Flat Head Nylon Screws, Nuts & Washers Six thread sizes (#4-40 to 1/4-20) in Assorted Lengths (1/4" to 1")	500	Y16K

# HEXAGON NUTS

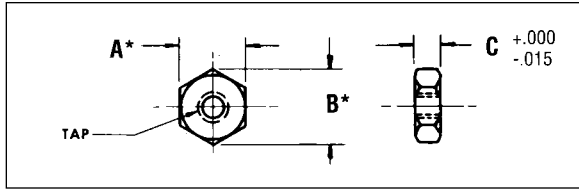

Material: 300 Series Stainless Steel

## NUTS, WASHERS & LOCKWASHERS KITS

Description of Contents	Number of Parts	Part No.
Nuts-Washers-Lockwashers- Stainless Steel-Assorted sizes from #0-80 through #10-32.	1900	Y6K

Tap	A	B	C	Part No.
# 0-80	5/32	.180	.050	Y8-0
# 2-56	3/16	.217	.066	Y8-2
# 4-40	1/4	.289	.098	Y8-4
# 6-32	5/16	.361	.114	Y8-6
# 8-32	11/32	.397	.130	Y8-8
#10-32	3/8	.433	.130	Y8-10
1/4-20	7/16	.505	.193	Y8-12

Sold In Increments of 25 pieces.

### \*Tolerance

Part No.	A +000	B +000
Y8-6	-.010	-.017
Y8-8	-.012	-.019
Y8-10	-.013	-.020
Y8-12	-.015	-.023

# METRIC HEXAGON NUTS

All Dimensions In Millimeters

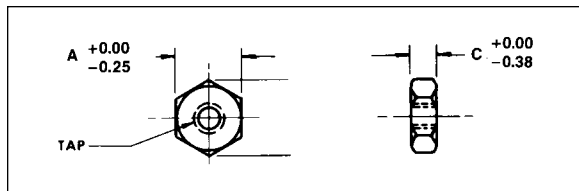

Material: 300 Series Stainless Steel.

## METRIC NUTS, WASHERS & LOCKWASHERS KITS

Description of Contents	Number of Parts	Part No.
Nuts-Washers-Lockwashers, stainless steel. Assorted sizes from M1.6 x 0.35 to M6 x 1.	800	MAK5

Size	A	C	Part No.
M1.6 x 0.35	3.2	1.3	MHN1-2
M2 x 0.4	4	1.6	MHN1-3
M3 x 0.5	5.5	2.4	MHN1-4
M4 x 0.7	7	3.2	MHN1-5
M5 x 0.8	8	4	MHN1-6
M6 x 1	10	5	MHN1-7
M8 x 1.25	13	6.5	MHN1-8
M10 x 1.5	17	8	MHN1-9

Sold In Increments of 25 pieces.

# PRECISION WASHERS

Machined

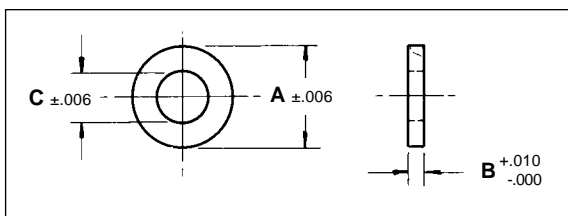

Material: 300 Series Stainless Steel

Screw Size (Ref.)	A	B	C	Part No.
# 4	1/4		.116	3150
# 6	5/16	1/16	.144	3151
# 8	3/8		.169	3152
#10	7/16	5/64	.196	3153
1/4	1/2		.257	3154
5/16	5/8	3/32	.323	3155
3/8	3/4		.386	3156

# PLAIN & LOCK WASHERS & TOOTH LOCK WASHERS

Stamped Washers

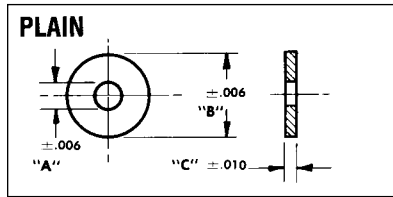
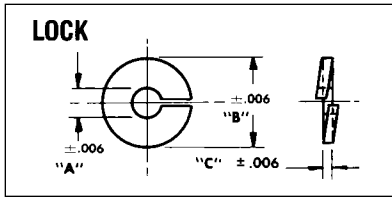

Material: 300 Series Stainless Steel

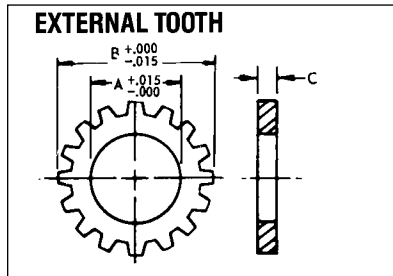
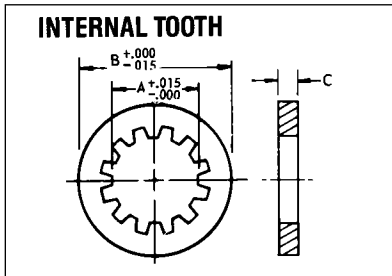

Material: 400 Series Stainless Steel

NUTS, WASHERS & LOCKWASHERS KITS		
Description of Contents	Number of Parts	Part No.
Lockwashers-Tooth-Stainless Steel Internal and External for Eight Screw Sizes (#2 to 3/8).	500	Y17K

Screw Size (Ref.)	Lock Washer				Plain Washer			
	A	B	C	Part No.	A	B	C	Part No.
#00	.056	.093	.020	Y6-00	.053	.108	.015	Y7-00
#0	.066	.110	.020	Y6-0	.062	.156	.020	Y7-0
#1	.075	.142	.020	Y6-1	.078	.187	.020	Y7-1
# 2	.093	.166	.020	Y6-2	.089	.187	.031	Y7-2
# 4	.120	.203	.025	Y6-4	.125	.312	.031	Y7-4
# 6	.146	.244	.031	Y6-6	.149	.375	.031	Y7-6
# 8	.173	.287	.040	Y6-8	.174	.375	.031	Y7-8
#10	.199	.327	.047	Y6-10	.203	.438	.063	Y7-10
1/4	.261	.483	.062	Y6-11	.265	.500	.063	Y7-11
5/16	—	—	—	—	.328	.562	.063	Y7-12
3/8	—	—	—	—	.390	.625	.063	Y7-13

Screw Size	A	B	C	Type of Washer	Part No.
# 2	.089	.185 .200	.013	Internal	Y10-1
				External	Y10-2
# 4	.116	.265 .255	.015	Internal	Y10-3
				External	Y10-4
# 6	.142	.288 .317	.018 .020	Internal	Y10-5
				External	Y10-6
# 8	.168	.336 .381	.020	Internal	Y10-7
				External	Y10-8
#10	.195	.381 .406	.022	Internal	Y10-9
				External	Y10-10
1/4	.256	.478 .506	.025	Internal	Y10-11
				External	Y10-12

Screw Size (Ref.) #00, #0 & #1 are sold in increments of 100 pieces.  
Screw Size (Ref.) #2 & #4 are sold in increments of 50 pieces.  
All other Screw Size (Ref.) are sold in increments of 25 pieces.

# METRIC PLAIN & LOCK WASHERS & TOOTH LOCK WASHERS

Stamped Washers ■ All Dimensions In Millimeters

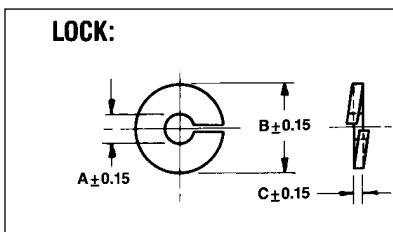
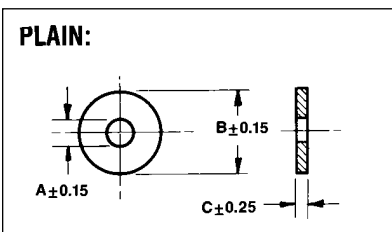

Material: 300 Series Stainless Steel

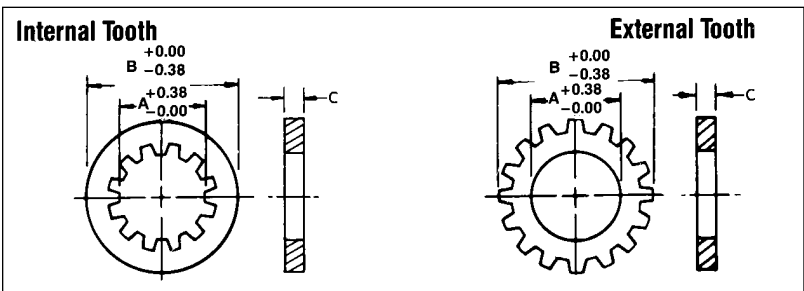

Material: 300 Series Stainless Steel

METRIC NUTS, WASHERS & LOCKWASHERS KITS		
Description of Contents	Number of Parts	Part No.
Lockwashers-Tooth, stainless steel. Internal and external for eight screw sizes (M2 to M8).	300	MAK12

Screw Size (Ref.)	Lock Washer				Plain Washer			
	A	B	C	Part No.	A	B	C	Part No.
M1.6	—	—	—	—	1.7	4.0	0.3	MWS2-1
M2	—	—	—	—	2.2	5.0	0.3	MWS2-2
M3	3.1	6.2	0.8	MWS1-3	3.2	7.0	0.5	MWS2-3
M4	4.1	7.6	0.9	MWS1-4	4.3	9.0	0.8	MWS2-4
M5	5.1	9.2	1.2	MWS1-5	5.3	10.0	1.0	MWS2-5
M6	6.1	11.8	1.6	MWS1-6	6.4	12.5	1.6	MWS2-6
M8	8.1	14.8	2.0	MWS1-7	8.4	17.0	1.6	MWS2-7
M10	10.2	18.1	2.2	MWS1-8	10.5	21.0	2.0	MWS2-8

Screw Size (Ref.)	A	B	C	Type of Washer	Part No.
M3	3.2	6.0	0.4	Internal	MWS3-3
				External	MWS4-3
M4	4.3	8.0	0.5	Internal	MWS3-4
				External	MWS4-4
M5	5.3	10.0	0.6	Internal	MWS3-5
				External	MWS4-5
M6	6.4	11.0	0.7	Internal	MWS3-6
				External	MWS4-6
M8	8.4	15.0	0.8	Internal	MWS3-7
				External	MWS4-7
M10	10.5	18.0	0.9	Internal	MWS3-8
				External	MWS4-8

# BELLEVILLE SPRING WASHER

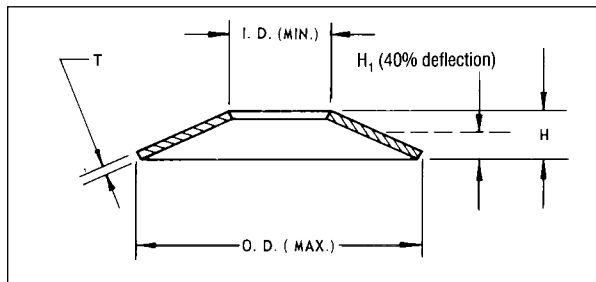

Inside Dia.	Outside Dia.	T	H (Approx.)	H <sub>1</sub> (Approx.)	*P <sub>1</sub> ± 10%	Calculated Load at Flat Position—Lbs.	Part No.
.093	.187	.010	.015	.013	14	25	D6-20
.125	.250	.0133	.020	.017	23	43	D6-21
.156	.312	.0166	.025	.021	37	67	D6-22
.190	.375	.020	.030	.025	54	99	D6-23
.255	.500	.025	.038	.031	85	144	D6-24
.317	.625	.032	.048	.040	130	234	D6-25
.380	.750	.040	.059	.049	211	373	D6-26
.505	1.000	.050	.075	.062	306	540	D6-27

\*LOAD AT H<sub>1</sub>

Material: 300 Series Stainless Steel  
Spring Steel

## STACKED BELLEVILLE SPRING WASHERS

Deflection in a single Belleville Spring Washer is small. Series stacking increases the deflection in proportion to the number of washers, but the load remains the same as a single washer. Parallel stacking increases the load approximately proportional to the number of washers (a 5% to 10% load loss per washer is introduced).

## ADVANTAGES:

- Stainless Steel non-corrosive
- High loads in small space.
- Combine washers (series or parallel) to vary load carrying possibilities.

## BELLEVILLE SPRING WASHER KITS

Description of Contents	Number of Parts	Part No.
Belleville Spring Washers-Stainless Steel. Eight Sizes from .093 to .505 Inside Diameters.	150	Y13K

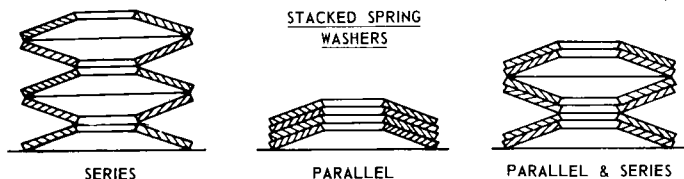

# METRIC BELLEVILLE SPRING WASHER

All Dimensions In Millimeters

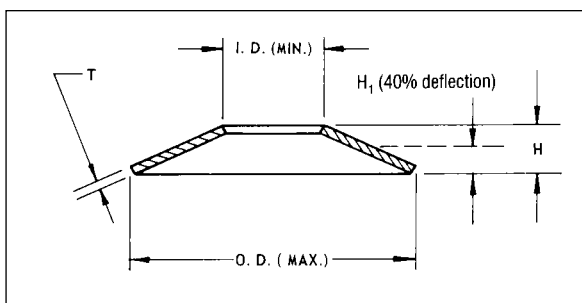

Inside Dia.	Outside Dia.	T	H (Approx.)	H <sub>1</sub> (Approx.)	*P <sub>1</sub> ± 10%	Load at Flat Position Newtons	Part No.
3.2	8	0.3	0.55	0.45	66	126	MBW1-1
4.2	8	0.4	0.60	0.52	120	267	MBW1-2
6.2	12.5	0.7	1.00	0.88	369	846	MBW1-3
8.2	18	0.8	1.30	1.10	465	977	MBW1-4
10.2	20	1.1	1.55	1.37	846	1967	MBW1-5
12.2	25	1.5	2.05	1.83	1615	3786	MBW1-6

\*LOAD AT H<sub>1</sub>

Material: Carbon Spring Steel,  
Bright Zinc Finish

## METRIC BELLEVILLE SPRING WASHER KITS

Description of Contents	Number of Parts	Part No.
Belleville Spring Washers, carbon spring steel, plated. Six sizes from 3.2 to 12.2 inside diameters.	120	MAK11

# CURVED WASHERS

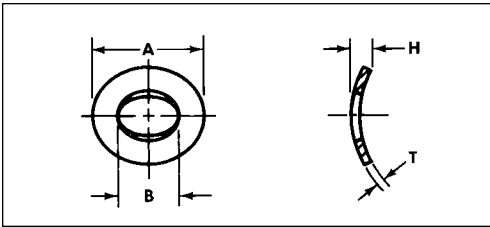

A	B	T	H (Approx.)	Hole Size	Screw Size	Part No.
.245	.135	.006	.034	1/4	# 5	D33-1
.270	.148	.007	.035	9/32	# 6	D33-2
.322	.174	.0075	.042	11/32	# 8	D33-3
.370	.200	.009	.047	3/8	#10	D33-4
.490	.265	.011	.063	1/2	1/4	D33-6
.612	.327	.013	.077	5/8	5/16	D33-7

Material: 300 Series Stainless Steel  
Spring Tempered

# CAPTIVE SCREWS

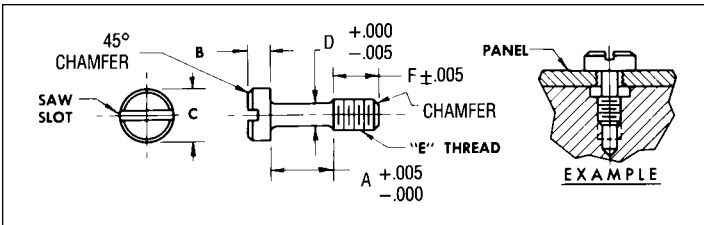

For Panel Thickness	A	B	C	D	E	F	Part No.
1/16	.281	1/8	1/4	.072	# 4-40	.187	Y9-1
1/8	.343	1/8	1/4	.072	# 4-40	.187	Y9-2
1/16	.312	1/8	9/32	.086	# 6-32	.218	Y9-3
1/8	.375	1/8	9/32	.086	# 6-32	.218	Y9-4
3/16	.437	1/8	9/32	.086	# 6-32	.218	Y9-5
1/8	.406	5/32	5/16	.114	# 8-32	.250	Y9-6
3/16	.468	5/32	5/16	.114	# 8-32	.250	Y9-7
1/4	.531	5/32	5/16	.114	# 8-32	.250	Y9-8
3/16	.531	3/16	3/8	.136	#10-32	.312	Y9-9
1/4	.593	3/16	3/8	.136	#10-32	.312	Y9-10

Material: 303 Stainless Steel

# METRIC CAPTIVE SCREWS

All Dimensions In Millimeters

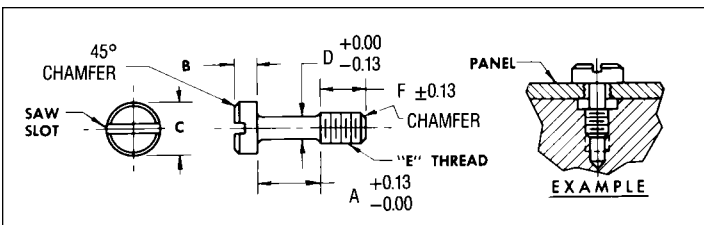

For Panel Thickness	A	B	C	D	E	F	Part No.
1.5	6.75	2	5.2	2.14	M3	4.50	MCS1-1
3	8.25	2	5.2	2.14	M3	4.50	MCS1-2
3	9.75	2.8	7	2.89	M4	6.00	MCS1-3
5	11.75	2.8	7	2.89	M4	6.00	MCS1-4
6	12.75	2.8	7	2.89	M4	6.00	MCS1-5
5	13.25	3.5	9	3.77	M5	7.50	MCS1-6
6	14.25	3.5	9	3.77	M5	7.50	MCS1-7

Material: 303 Stainless Steel

# RETAINING RINGS

## Internal, External, External-E Ring, Bowed Series

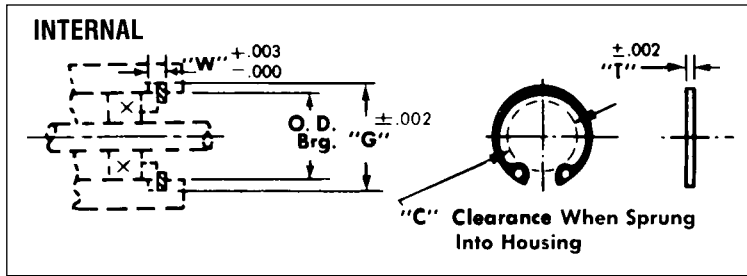

Material: PH 15-7 MO Stainless Steel

Maximum Shaft Dia. (Ref.)	Groove Dims.		T	C	O.D. Brg.	Part No.
	G	W				
.156	.397	.029	.025	.20	.375	Z1-1
.187	.530	.039	.035	.26	.500	Z1-2
.250	.665	.039	.035	.34	.625	Z1-3
.375	.931	.046	.042	.54	.875	Z1-5

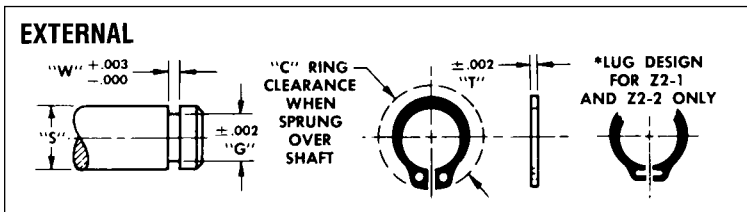

Material: PH 15-7 MO Stainless Steel  
\*Beryllium Copper

Shaft Dia. (Ref.)	Groove Dims.		T	C	Part No.
	G	W			
.125	.117	.012	.010	.22	*Z2-1
.187	.175	.018	.015	.30	*Z2-2
.250	.230	.029	.025	.45	Z2-3
.375	.352	.029	.025	.61	Z2-5
.500	.468	.039	.035	.77	Z2-6

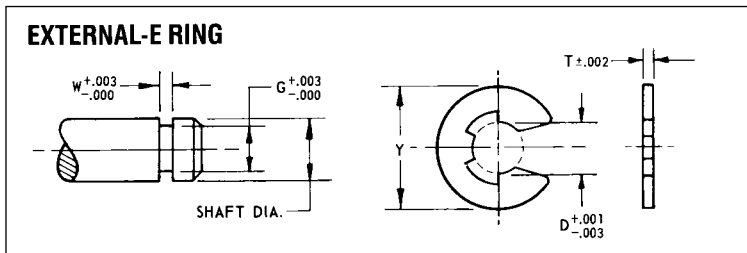

Material: PH 15-7 MO Stainless Steel

Shaft Dia.	Groove Dims.		Y	D	T	Part No.
	G	W				
.093	.074	.018	.187	.073	.015	Z3-7
.125	.095	.018	.230	.094	.015	Z3-1
.156	.116	.029	.282	.114	.025	Z3-8
.187	.147	.029	.335	.145	.025	Z3-2
.250	.210	.029	.527	.207	.025	Z3-3
.312	.250	.029	.500	.243	.025	Z3-4
.375	.303	.039	.660	.300	.035	Z3-5
.500	.396	.046	.800	.392	.042	Z3-6

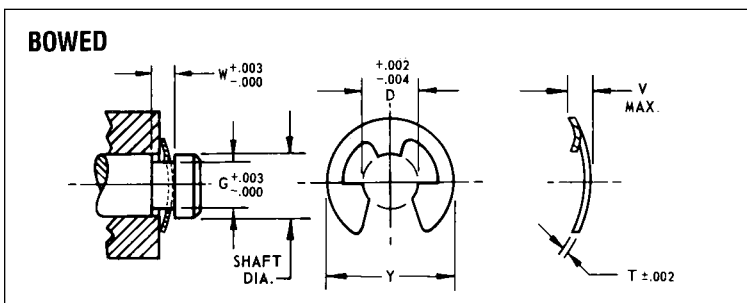

Material: PH 15-7 MO Stainless Steel

Shaft Dia.	Groove Dims.		Y	D	T	V Max.	Part No.
	G	W					
.125	.095	.022	.230	.094	.010	.033	Z4-1
.187	.147	.030	.335	.145	.015	.043	Z4-2
.250	.210	.049	.527	.207	.025	.067	Z4-3
.312	.250	.047	.500	.243	.025	.065	Z4-4
.375	.303	.060	.660	.300	.035	.076	Z4-5
.500	.395	.073	.800	.392	.042	.093	Z4-6

### RETAINING RINGS KIT

Description of Contents	Number of Parts	Part No.
Retaining Rings-Stainless Steel Bearing, Shaft, and Snap Types for shaft sizes 1/8" to 1/4".	400	Y9K



# METRIC RETAINING RINGS

All Dimensions In Millimeters ■ Internal, External, External-E Ring Series

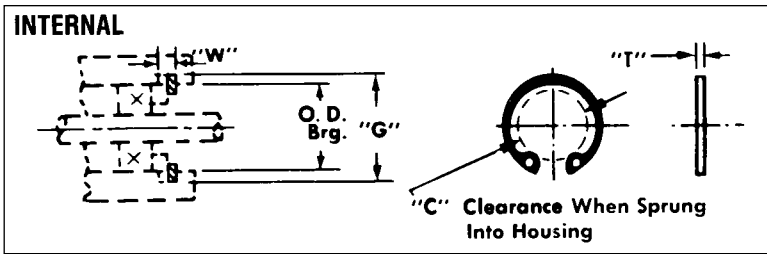

O.D. BRG.	Groove Dims.			T	C	Part No.
	G	tol	W (min.)			
10	10.4	+0.11	1.1	1.0	4.0	MRR1-2
11	11.4	+0.11	1.1	1.0	4.8	MRR1-3
13	13.6	+0.11	1.1	1.0	6.4	MRR1-4
15	15.7	+0.11	1.1	1.0	8.3	MRR1-5
16	16.8	+0.11	1.1	1.0	9.2	MRR1-6
19	20.0	+0.15	1.1	1.0	11.8	MRR1-7
22	23.0	+0.15	1.1	1.0	14.6	MRR1-8
26	27.2	+0.21	1.3	1.2	17.8	MRR1-9

Material: Spring Steel, Bright Zinc Finish

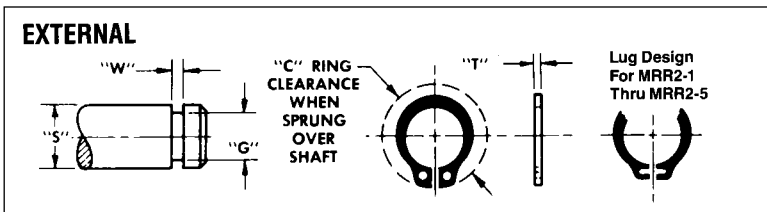

Shaft Dia. (S)	Groove Dims.			T	C	Part No.
	G	tol	W (min.)			
4	3.8	-0.04	0.5	0.4	8.2	MRR2-2
5	4.8	-0.04	0.7	0.6	9.8	MRR2-3
6	5.7	-0.04	0.8	0.7	11.1	MRR2-4
8	7.6	-0.06	0.9	0.8	14.0	MRR2-5
10	9.6	-0.11	1.1	1.0	16.2	MRR2-6
12	11.5	-0.11	1.1	1.0	18.1	MRR2-7

Material: Spring Steel, Bright Zinc Finish

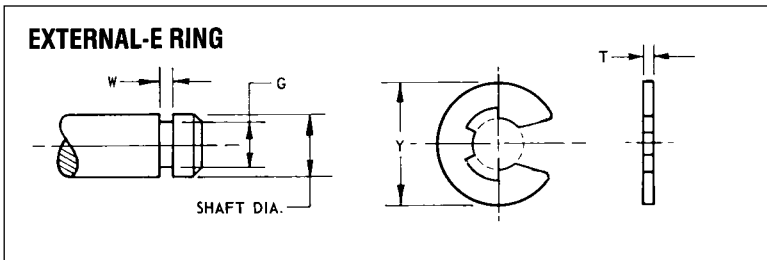

Shaft Dia.	Groove Dims.			Y (Filled)	T (max.)	Part No.
	G	tol	W (min.)			
2	1.2	-0.06	0.34	3.0	0.32	MRR3-1
3	1.9	-0.06	0.54	4.5	0.52	MRR3-2
4	2.3	-0.06	0.64	6.0	0.62	MRR3-3
5	3.2	-0.07	0.64	7.0	0.62	MRR3-4
6	4.0	-0.07	0.74	9.0	0.72	MRR3-5
8	5.0	-0.07	0.74	11.0	0.72	MRR3-6
10	7.0	-0.09	0.94	14.0	0.92	MRR3-7
12	8.0	-0.09	1.05	16.0	1.03	MRR3-8

Material: Spring Steel, Bright Zinc Finish

## METRIC RETAINING RINGS KIT

Description of Contents	Number of Parts	Part No.
Retaining Rings, spring steel, zinc plated. Bearing, shaft and snap type for shaft sizes 3 to 5mm.	400	MAK8

# RETAINING RINGS

Gripping External Series

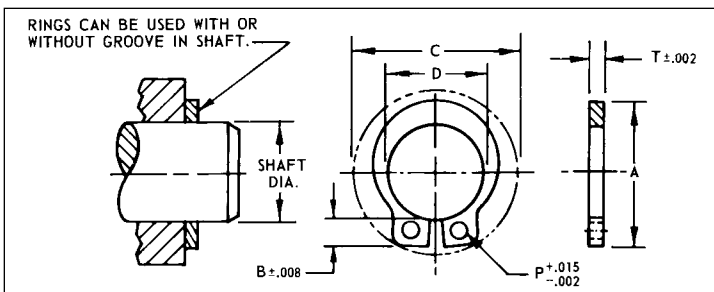

Shaft Dia.	A (Ref.)	B	C	D	T	P Dia.	Part No.
.125	.268	.078	.33	.120	.025	.042	Z5-1
.187	.364	.097	.44	.181	.035	.051	Z5-2
.250	.437	.097	.49	.238	.035	.051	Z5-3
.375	.620	.141	.74	.354	.042	.078	Z5-4
.500	.768	.158	.90	.470	.050	.078	Z5-5

Material: PH 15-7 MO Stainless Steel